

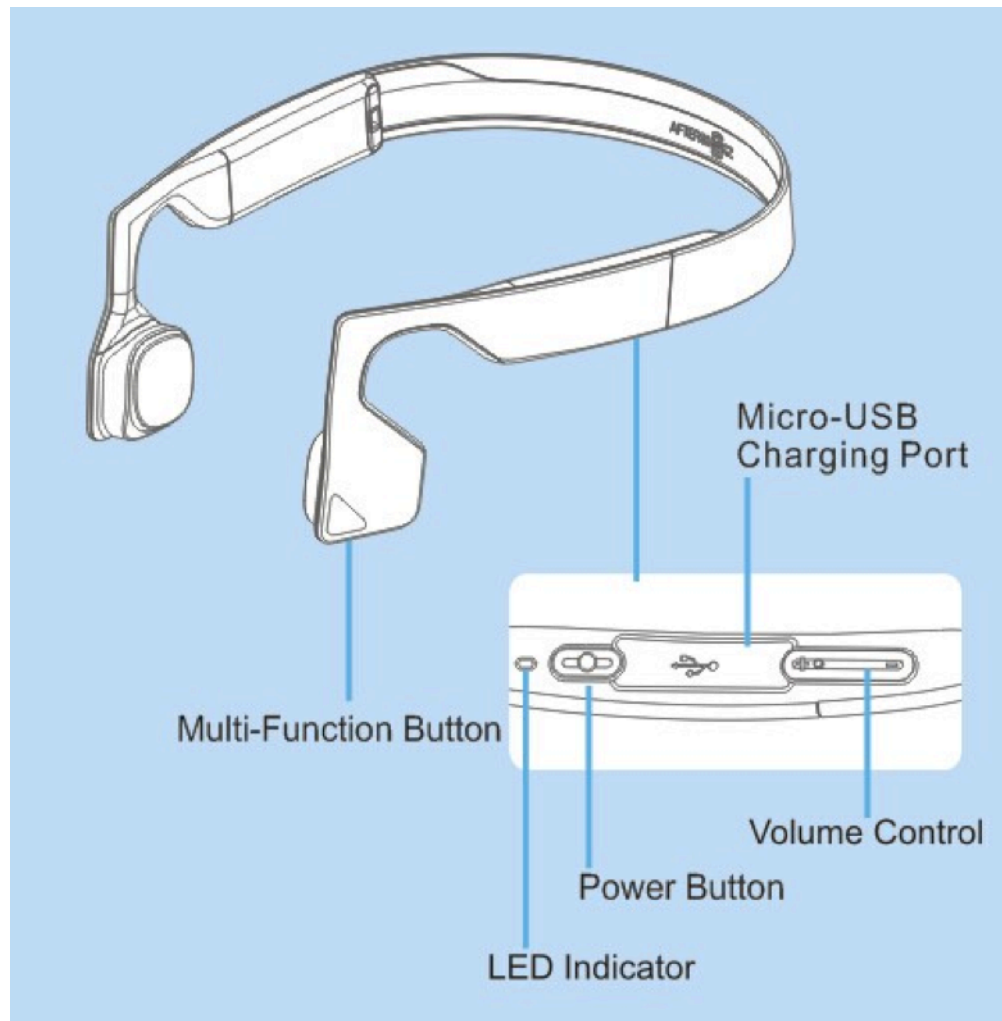

## BLUEZ 2

### WIRELESS BONE CONDUCTION HEADPHONES



#### Parts descriptions

- Transducers: Two soft pads, each about the size of a thumbnail, that rest on the cheekbones, just ahead of the ear canal. The Transducers are housed on both ends of the headphones.



- Multi-Function Button: Triangular button located on the outside of the left transducer housing. The Multi-Function Button is raised slightly above the surface of the transducer housing. This button is used in a variety of ways and will be further explained in this document.

Note: When worn properly, with the transducers rest on the cheekbones just ahead of the ear canals (like eyeglasses worn backwards). On the right side of the headset, there are three controls. Starting at the back is the Volume Control, in the middle is the Micro-USB Charging Port and at the front, the Power Button (with a small LED light).

- Volume Control: The Volume Control is a rocker switch, located on the right hand side of the device. There is a raised dot at the front, which increases volume, while the opposite end of the rocker switch decreases volume.
- Micro-USB Charging Port: The Micro-USB Charging Port is located on the right side of the headphones (as worn) and enclosed by a small protective hinged cover. The hinged cover can be lifted by using a fingernail. When the hinged cover is lifted, the Micro-USB charging port is revealed.
- Power Button: The Power Button is a small raised button located next to the Micro-USB Charging port, closest to the left transducer. When wearing the headphones, press the Power Button to turn on the device. When powering on, the headphones will vibrate and Audrey's voice will prompt with the phrase: "Welcome to Bluez 2". When powering off, the headphones will vibrate and play four descending beeps, then turn off.
- LED Indicator: The LED Indicator, near the Power Button, is a small light that indicates charging status visually. When fully charged, the LED Indicator will appear blue, and when the device is being charged, the LED Indicator will appear red.



### Accessories

- Adjustable Tension Band
- Micro-USB Charging Cable
- Reflective Stickers
- Weatherproof Storage Pouch
- Warranty Registration Card

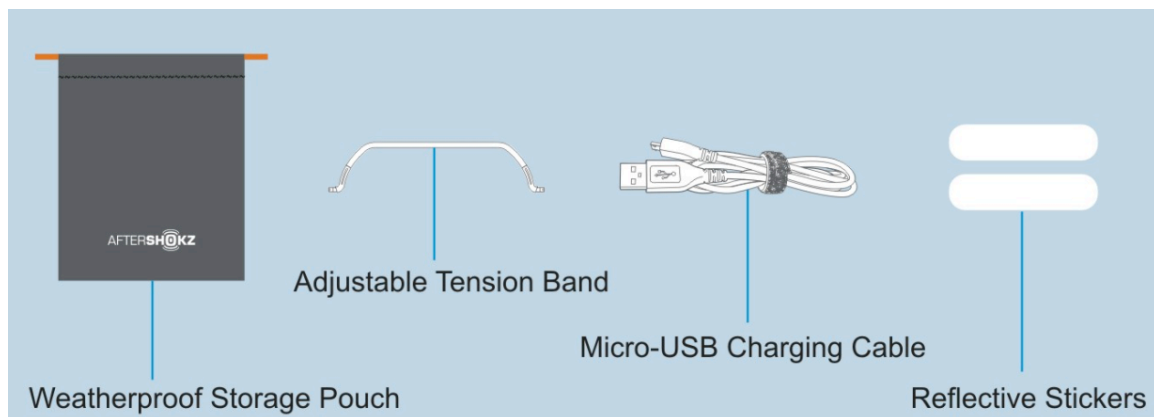

### What's special?

- Bluez 2 are stereo Bluetooth headphones with wireless phone and music functions that rely on bone conduction technology to transmit sound.
- The patent-pending OpenFit™ design promises ambient sound awareness and extended comfort that is unmatched with traditional headphones.
- PremiumPitch™ is our patent-pending technology that provides the finest and most detailed audio.
- LeakSlayer™ is a patent-pending feature that decreases natural sound leakage.
- A nanotechnology coating and watertight rubber gaskets repel sweat and moisture from the inside out.
- Equalization presets customize bass and vibration on the go.
- Dual noise canceling microphones exclude surrounding noise, effectively enhancing speech.
- Audrey Says™ voice prompts seamlessly guides you through power, pair, play and talk.



### How to wear

- Begin by holding the headphones horizontally, with the transducer side facing up, closest to your body. Lift the headphones over your head, so the back of the wraparound headband sets in place at the base of the head, and the transducers rest on your cheekbones in front of your ears (not nested inside or covering your ears).

## HOW TO WEAR



Note: The Adjustable Tension Band is recommended for those who prefer a more secure fit around the back of their heads. The Adjustable Tension Band is a flexible silicon band with two tough pins at each end, which is included in the package, along with the Micro-USB Charging Cable in a plastic zippered bag.

### How to use the Adjustable Tension Band

1. Put the headphones on a table horizontally, with the transducer side facing up, closest to your body.
2. Put the Adjustable Tension Band along the interior of the headband. Twist the



Adjustable Tension Band to a semicircle, along the inside of the headband, with the pins facing outwards.

3. There is a hole in each inner side of headband. Insert the pins into the holes in the inside of the headband.

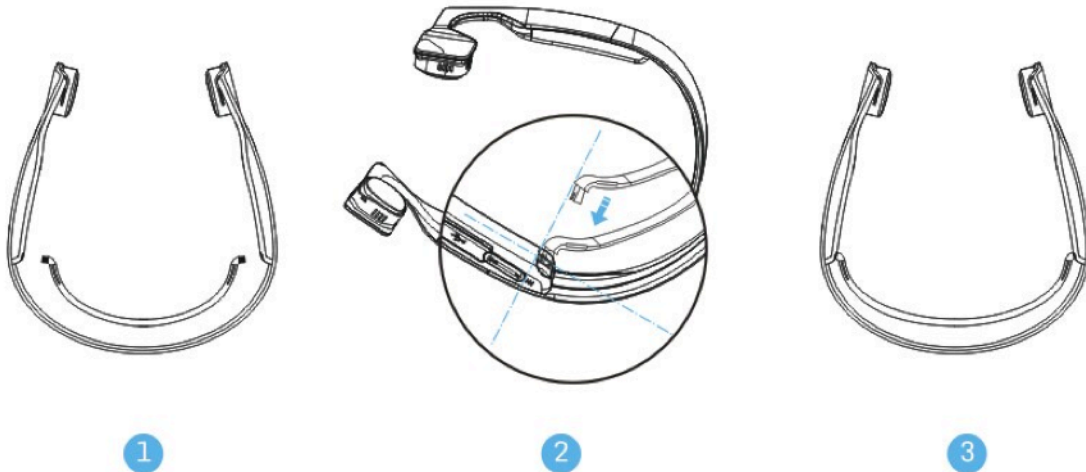

### How to use the Reflective Stickers

1. There are two Reflective Stickers provided for increasing visibility in darkness. They are packed together with the Adjustable Tension Band and the Micro-USB Charging Cable in a plastic zippered bag.
2. Peel off one Reflective Sticker.
3. Affix Reflective Sticker to the back exterior of the headband.
4. The second Reflective Sticker is provided as a replacement.

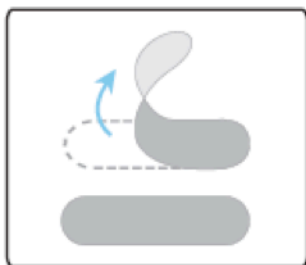

1



2



## How to operate Bluez 2

- **To turn on/off:**  
Hold down the Power Button for two seconds to turn on/off. When powering on, the headphones will vibrate and Audrey's voice will prompt with the phrase: "Welcome to Bluez 2". When powering off, the headphones will vibrate and play four descending beeps, then turn off.
- **Pairing:**
  1. While the device is turned off, press and hold the Power Button for five seconds, at which point the LED Indicator will begin flashing in alternating red/blue and Audrey's voice will prompt by the word: "pairing".
  2. On the electronic device that you're pairing your headphones with, locate the Bluetooth menu and select "Bluez 2 by AfterShokz". Enter "0000" if a password is required.
  3. Bluez 2 will be connected within seconds and Audrey's voice will prompt with the word, "Device one connected".

Note: If the Power Button is pressed and held for two seconds and then released, Bluez 2 will turn on and automatically reconnect with the previously paired device within 10 seconds.

If the headphones are out of range (more than 33 feet /10 meters) while connected to a device, Bluez 2 will disconnect from the device, and there will be a single beep every 10 seconds. If the headphones are brought back to the range within three minutes, they will automatically reconnect and you will hear Audrey's voice prompt with the word, "connected". If Bluez 2 are disconnected for more than three minutes, you will need to press the Multi-Function Button on the headset to reconnect the device.

- **Charging:**  
Connect Bluez 2 to a standard USB port on your PC or wall charger with the Micro-USB Charging Cable. Bluez 2 will be fully charged within two hours. The LED Indicator will show solid red when charging, and will turn solid blue when the device is fully charged.

Note: Though the headphones may have power right out of the box, it's recommended that Bluez 2 be fully charged before their first use.



The battery is designed to last the life of the product. It should only be removed by a recycling facility. Any attempt to remove or replace your battery may damage the product and void the warranty.

- **Check battery status:**

Press the Volume Up/Down Button Audrey's voice will prompt with the terms, "battery high", "battery medium", "battery low" or "charge me".

Note: You can only check speaker volume status while Bluez 2 are in standby mode.

Audrey's voice will prompt you with, "Charge me" every two minutes when the battery is low, and the LED Indicator will blink slowly.

- **Reset:**

Enter pairing mode, then press and hold the Multi-Function Button and Volume Up/Down Buttons for three seconds, and you will hear two beeps. This will reset your headphones.

Note: Reset erases all paired devices stored in your headset.

- **Pause/play music:**

Click the Multi-Function Button once. The headphones will beep, and your music will pause/play.

- **Change music EQ setting:**

Hold the Volume Up and Volume Down button for two seconds. Audrey's voice will prompt you with the phrase "Equalization changed".

Note: EQ setting will reset to default if Bluez 2 is re-paired.

- **Adjust volume:**

Press the button with the dot on the rocker switch to increase the volume, and press the opposite end of the rocker switch to decrease the volume.

Note: Volume Control is only valid while Bluez 2 is playing music or in the call.

- **Skip to next song:**



Double click the Multi-Function Button to skip the song. The headphones will beep once, and the headphones will skip to the following song.

- **Answer or end a call:**  
Click Multi-Function Button to answer or end a call, followed along with two beeps or single beep separately.
- **Mute/unmute microphone:**  
Hold the Volume Up/Down Button for two seconds to mute or unmute a call. You will hear Audrey's voice prompt, "mute on" or "mute off".
- **Redial last number:**  
Double click the Multi-Function Button to redial last number; the voice prompt is "last number redial".
- **Voice dial:**  
Hold the Multi-Function Button for two seconds to start the function of voice dial.
- **Answer the second incoming call and hang up current call:**  
Press and hold the Multi-Function Button for two seconds.
- **Answer the second incoming call and hold on the current call:**  
Click the Multi-Function Button to answer the second incoming call, and click the Multi-Function Button again to switch to the previous phone call.

Note: Some features are phone/network dependent.

## Specifications

Transducer type: bone conduction transducers

Transducer sensitivity is  $100\pm 3\text{dB}$

Microphone sensitivity is  $-40\pm 3\text{dB}$

Frequency range is 20Hz~20KHz

Rechargeable lithium battery





Playback time is up to 6 hours

The battery will be fully charged in 2 hours

The standby time is up to 10 days

Wireless range: 33 feet/10 meters

Bluetooth version: 3.0

Compatible Bluetooth profiles: A2DP, AVRCP, HSP, HFP

Weight: 1.45 ounces/41 grams

### **Storage and maintenance**

- Store the headphones in a cool and dry place. The working temperature should be 0~45°C (32~113°F). Working in a cold/hot environment or highly humid area may reduce the battery life.
- If stored for a long period of time, recharge the headphones before using again.
- The headphones are water resistant, but are NOT waterproof. Please DO NOT submerge the headphones in water.
- Listening to headphones at a high volume may affect your hearing and the audio will be distorted.
- Clean the headphones with a soft dry cloth.
- Do not charge the headphones right after exercising, in case there's sweat inside the charging port. This could lead to the circuit burning while charging. Keep the charging port dry before connecting to the charger to reduce this risk.

Note: Design and specifications are subject to change without notice.

For the most up-to-date product information, please visit [aftershokz.com](http://aftershokz.com).

### **How to contact us**

AfterShokz  
6311 Fly Road  
Suite 106  
East Syracuse, NY 13057  
[sales@aftershokz.com](mailto:sales@aftershokz.com)



[aftershokz.com](https://aftershokz.com)

Note: If you need to return your product for repair, replacement or warranty service, please contact the AfterShokz Customer Support Center at: 1-315-218-0308 (United States).